

Thies Cumulus APP

FAQ / Frequently Asked Questions

9.1780.00.000



Station Overview **Station Administration** **Instantaneous Values** **Archive Values**

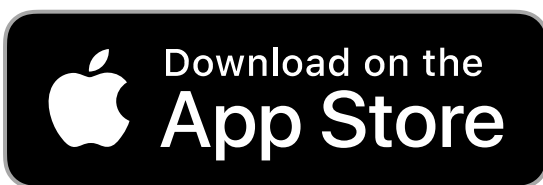

Dok. No. 021867/08/21

THE WORLD OF WEATHER DATA

Start screen after successful login: Station overview of the Puplic Group

All buttons of the APP and FAQ are stored as links.

FAQ

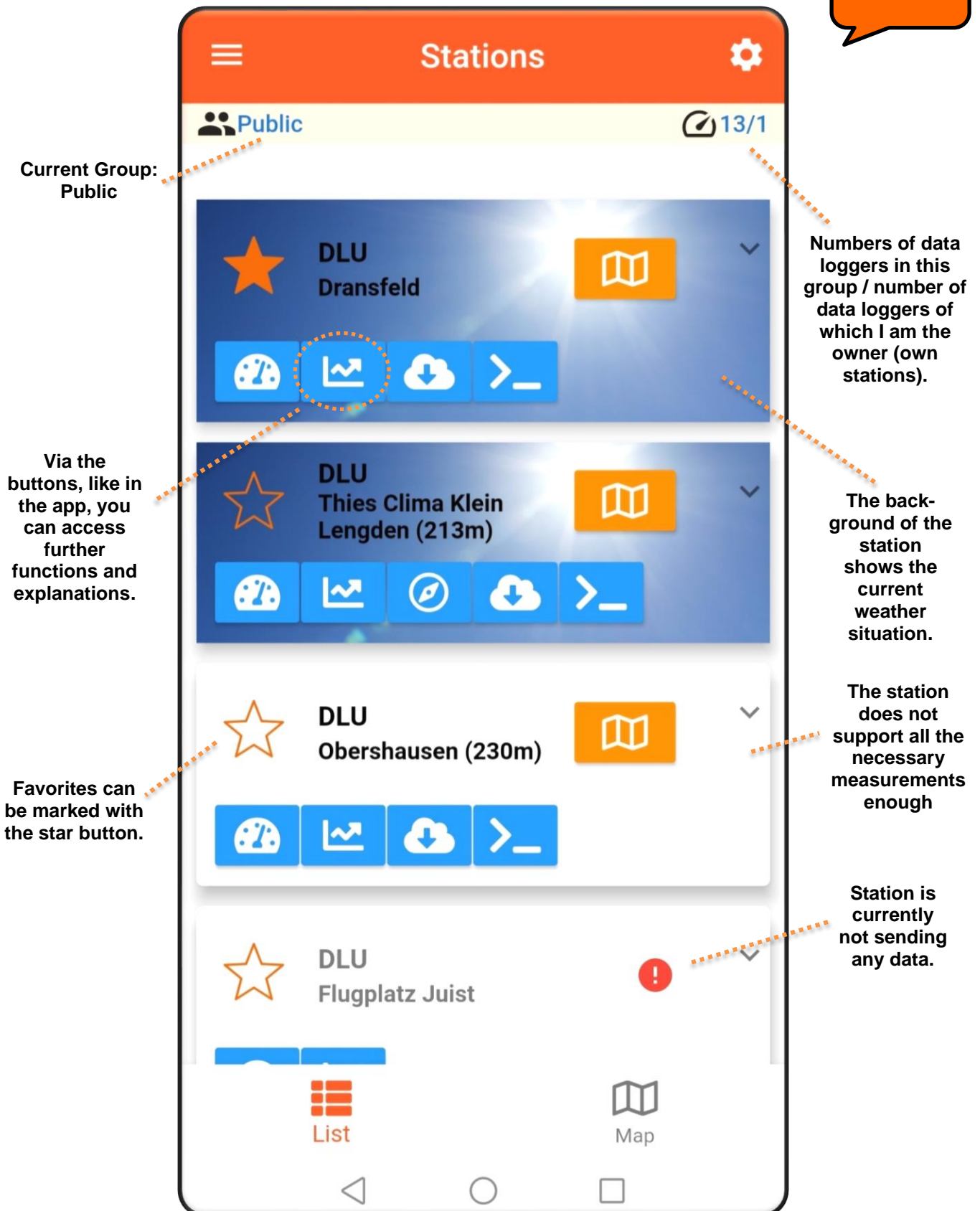

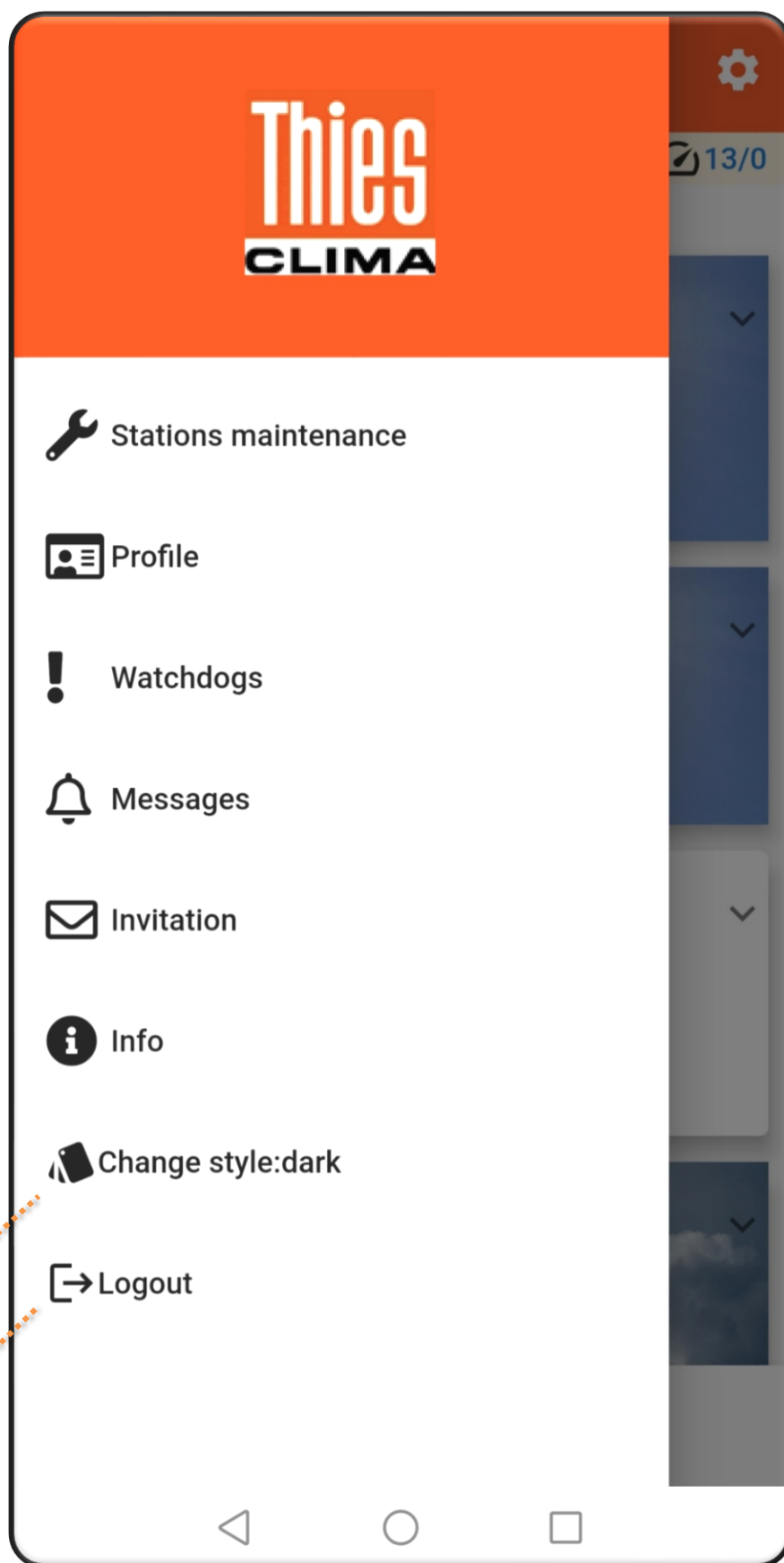

Collor setting
dark or light.

Logout off
the App.

With the **Stations maintenance** you can add or check out your stations.

FAQ

How can I register a station in the Cloud?

With the purchase of a DLU, a 32-digit code is supplied, which is shown as a QR code on the DLU display. By scanning the QR code with the app, the station is registered with your name.

Can a user register several stations in the Cloud?

Yes, a user can register any number of stations

Can there be stations in the cloud without an owner?

No, a station in the Cloud always has exactly one Owner

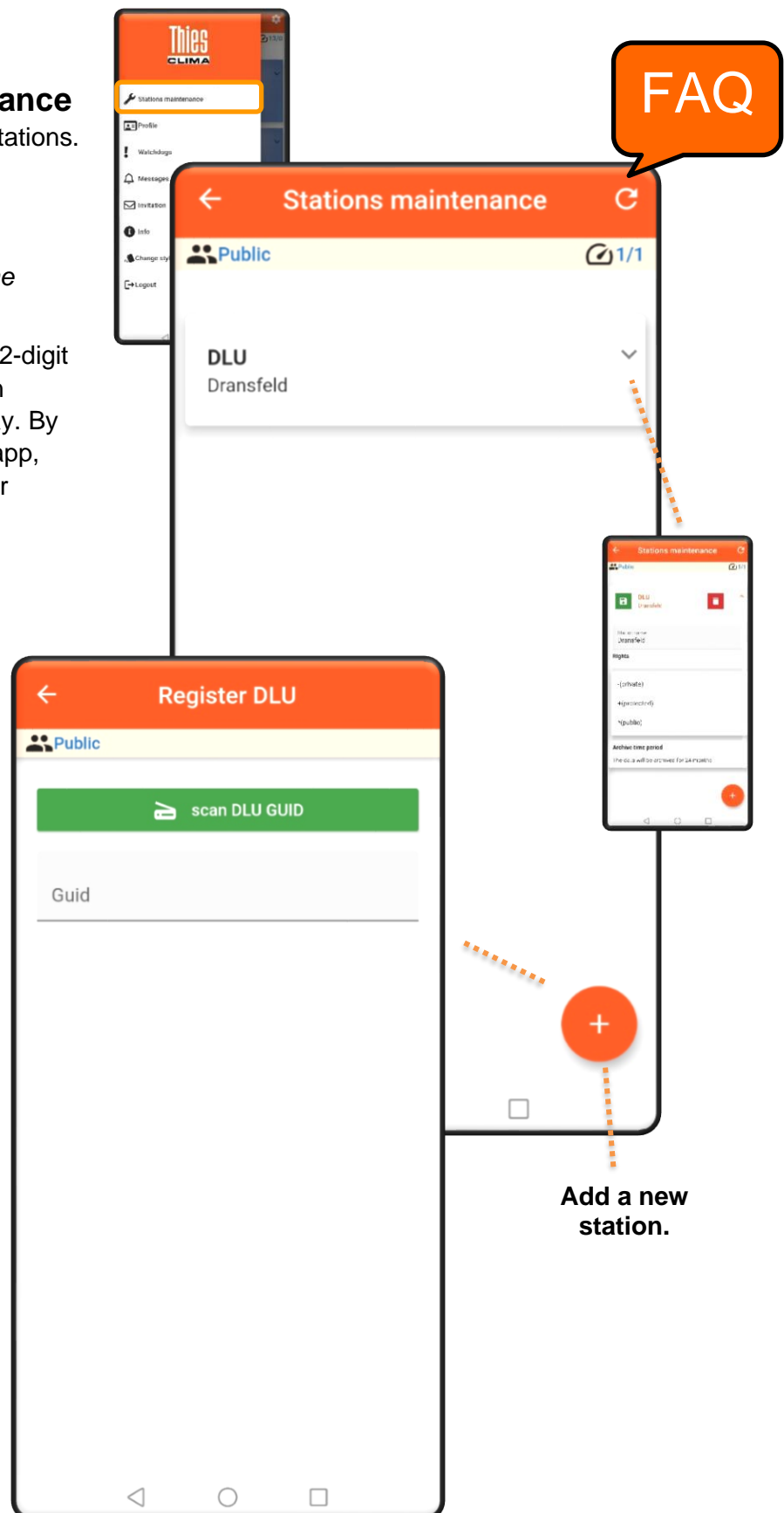

FAQ

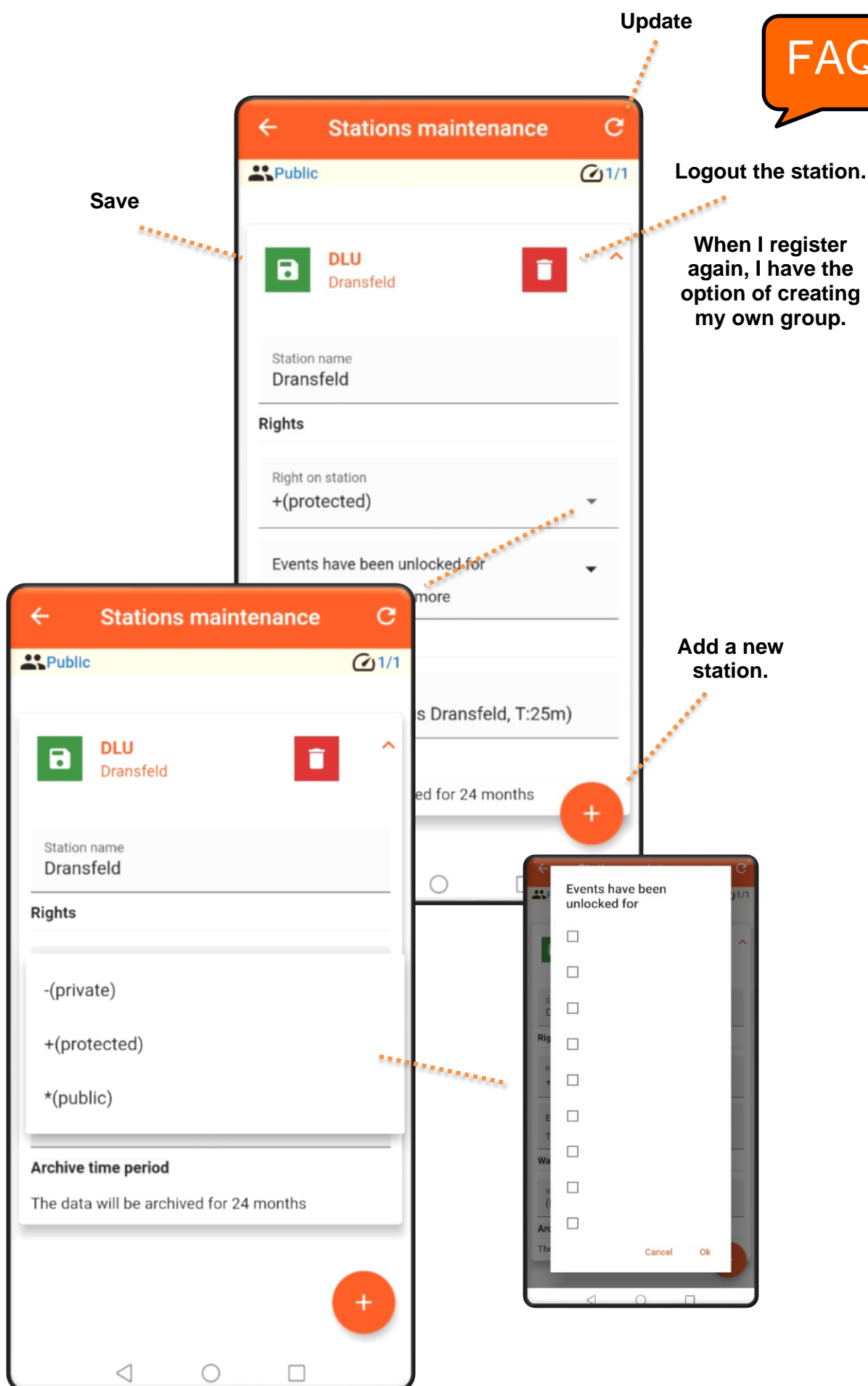

FAQ

The user is managed via the **Profile**. The password can be changed here.

What is the user concept?

There are three different types of user: Guest, owner and administrator

After the first registration you are automatically a guest. If you registered a device, you automatically become the owner. If a new group is created when a device is registered, you are also an administrator of the group.

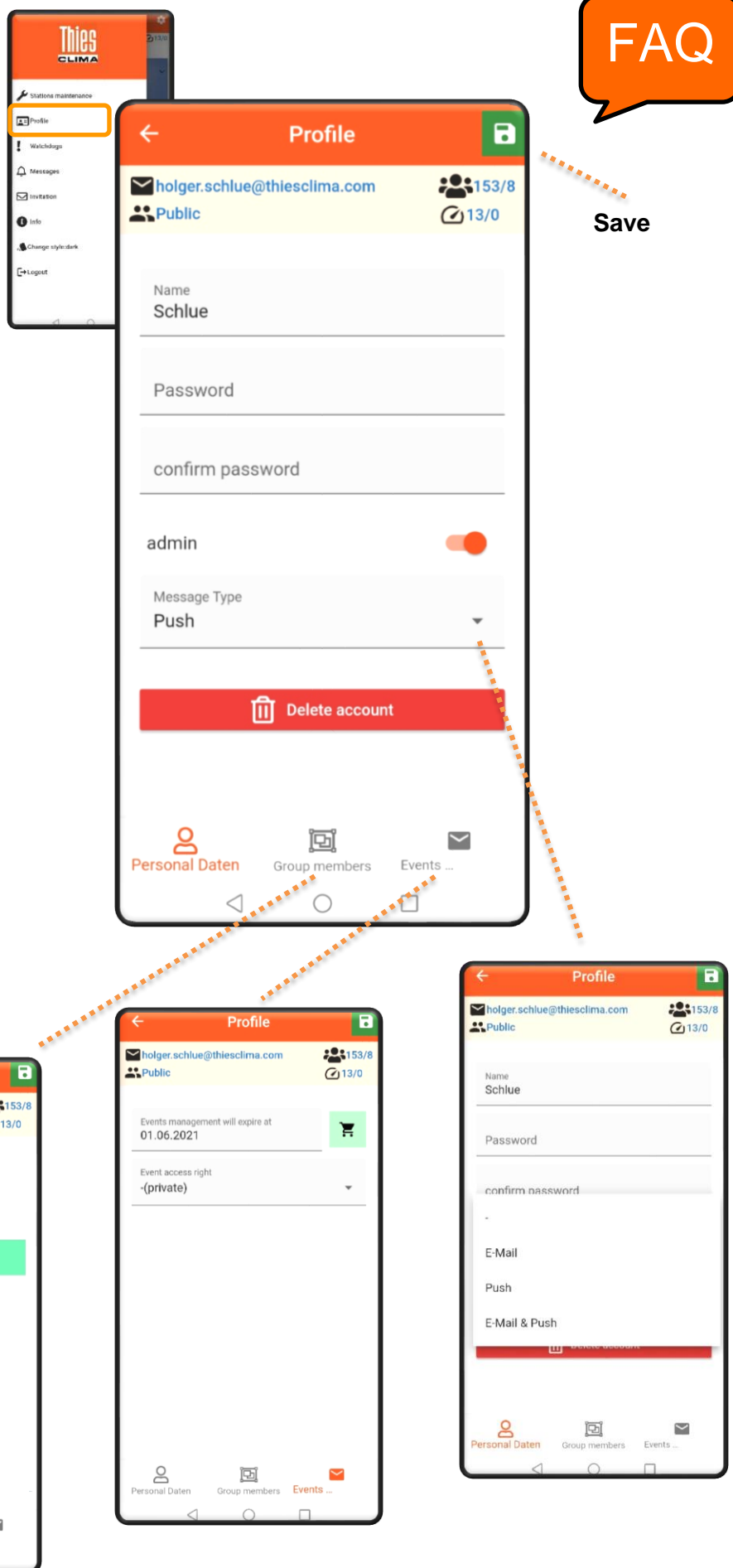

Via the button **Group members** you can manage your group. By default, 5 people in your group can manage. With an In-App purchase you can add, unlimited in time, another number of 10, 20 or 50 people.

In the **Event management** area, you can buy the watchdog and messages funktion as an In-App buy.

After downloading the app, all functions can be used free of charge for 1 month.

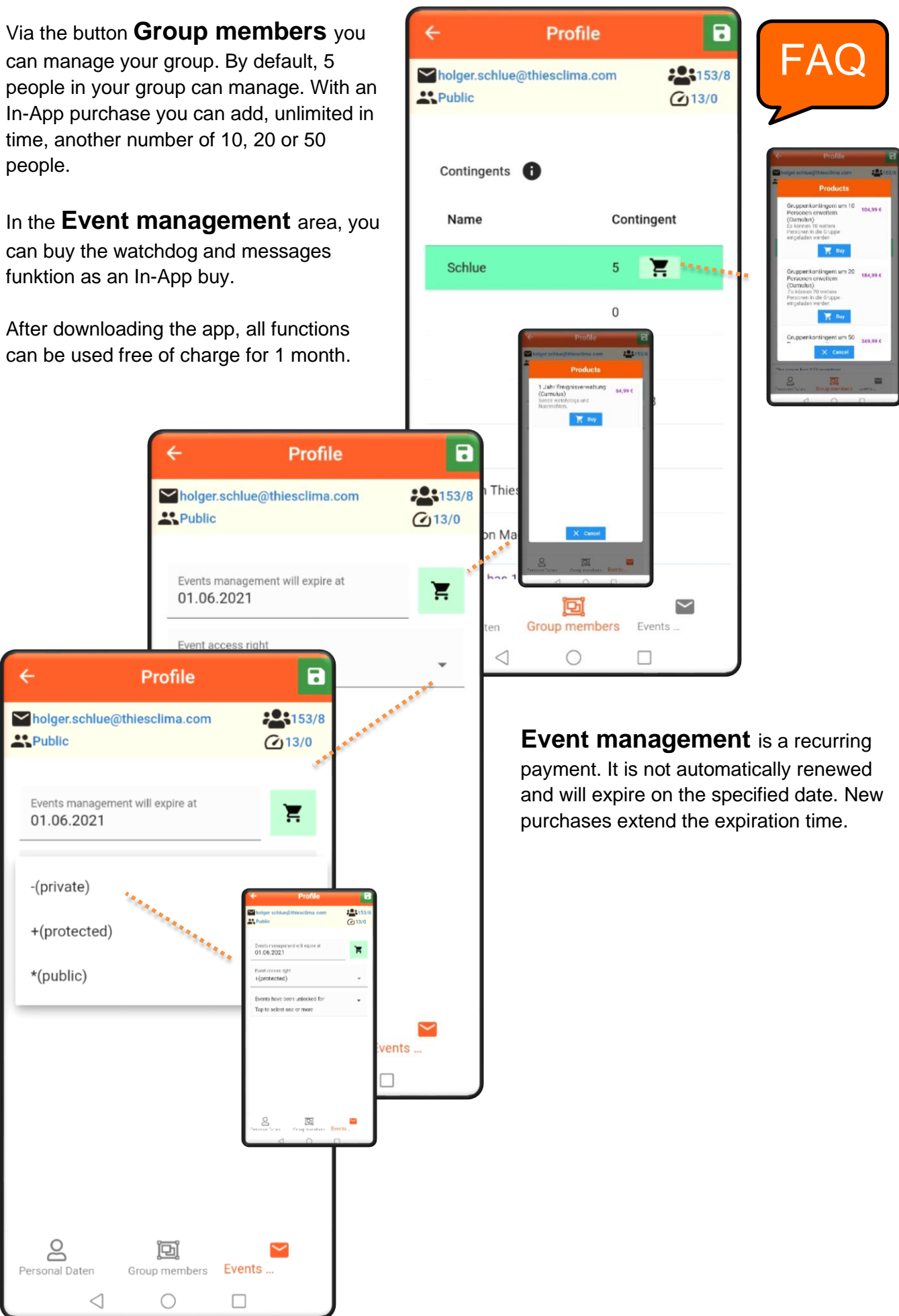

Event management is a recurring payment. It is not automatically renewed and will expire on the specified date. New purchases extend the expiration time.

In-App Product Overview

FAQ

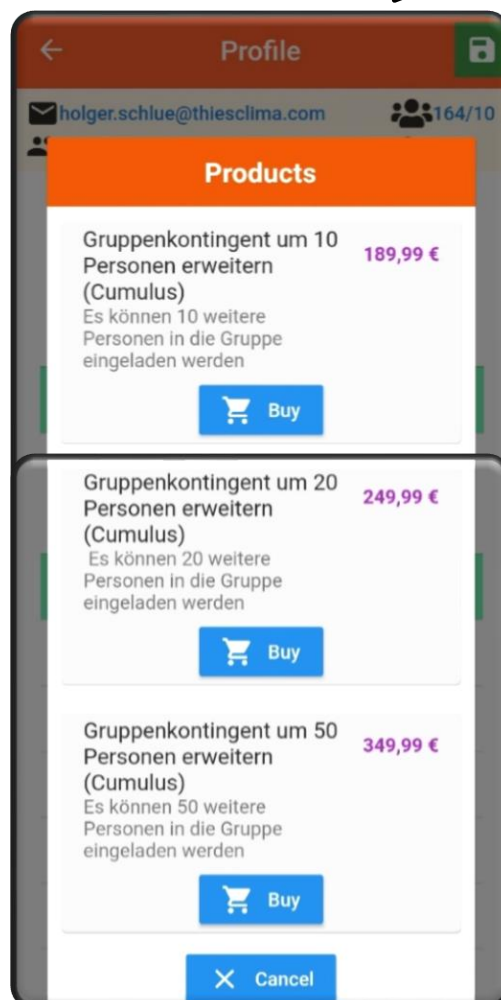
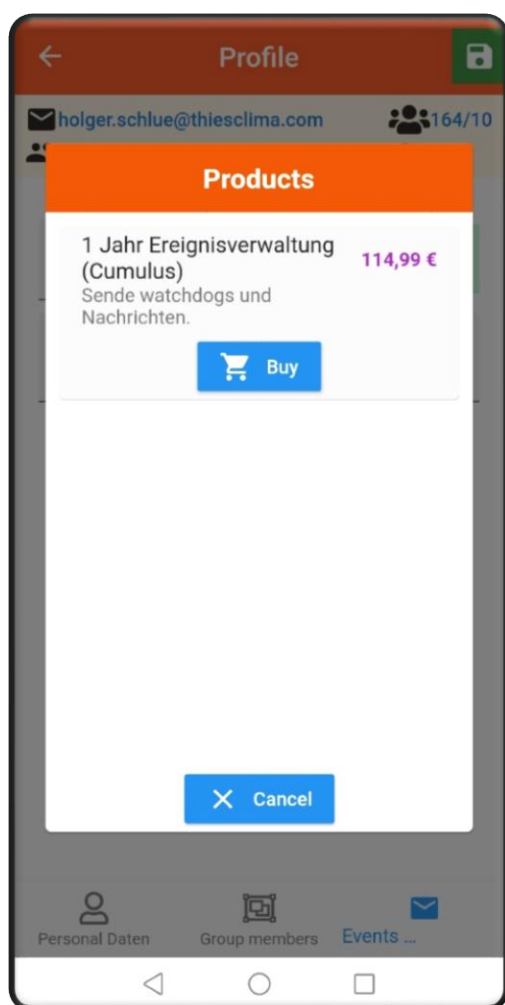

Organize messages

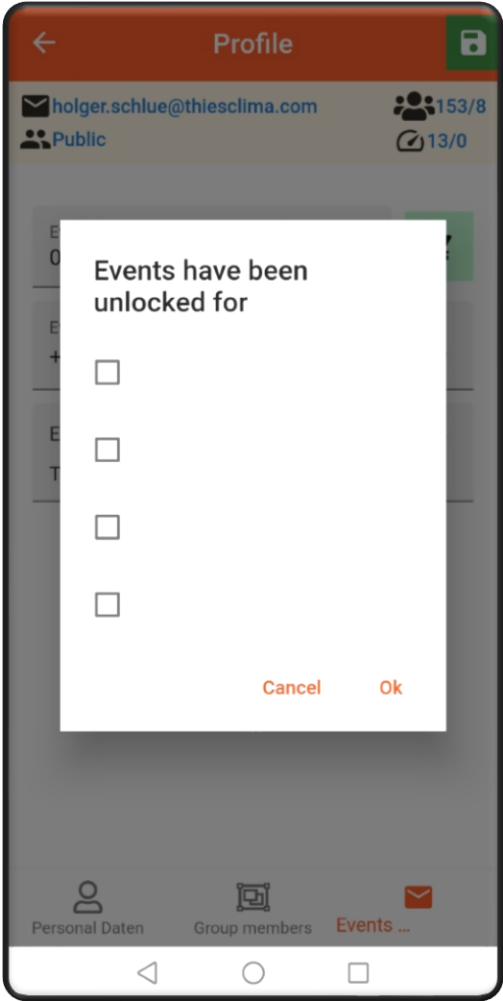
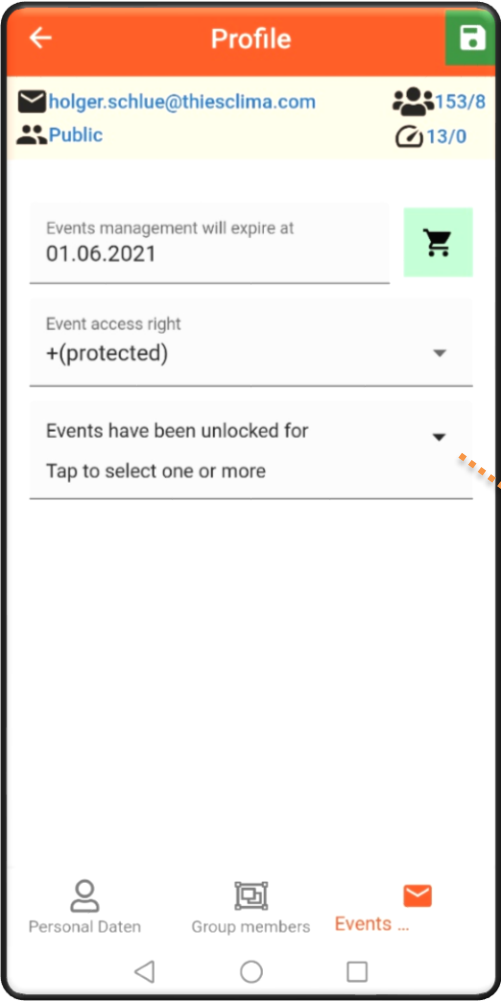

The **Watchdog** function is a function for failure detection of the system. You can configure the watchdog in this area of the app: Timeout period, type of message, to which people a message should be sent in the event of failure detection. You can configure the transmission type e-mail and / or push message via the button **Profile**. The i-Buttons are available in the app for further information.

In the area **Profil → Event management**, you can buy the watchdog and messages function as an Applnn buy.

After downloading the app, all functions be used free of charge for 1 month.

FAQ

Save

Delete

Select station.

Informationens

Select people from the group who should receive a watchdog info.

Create another watchdog.

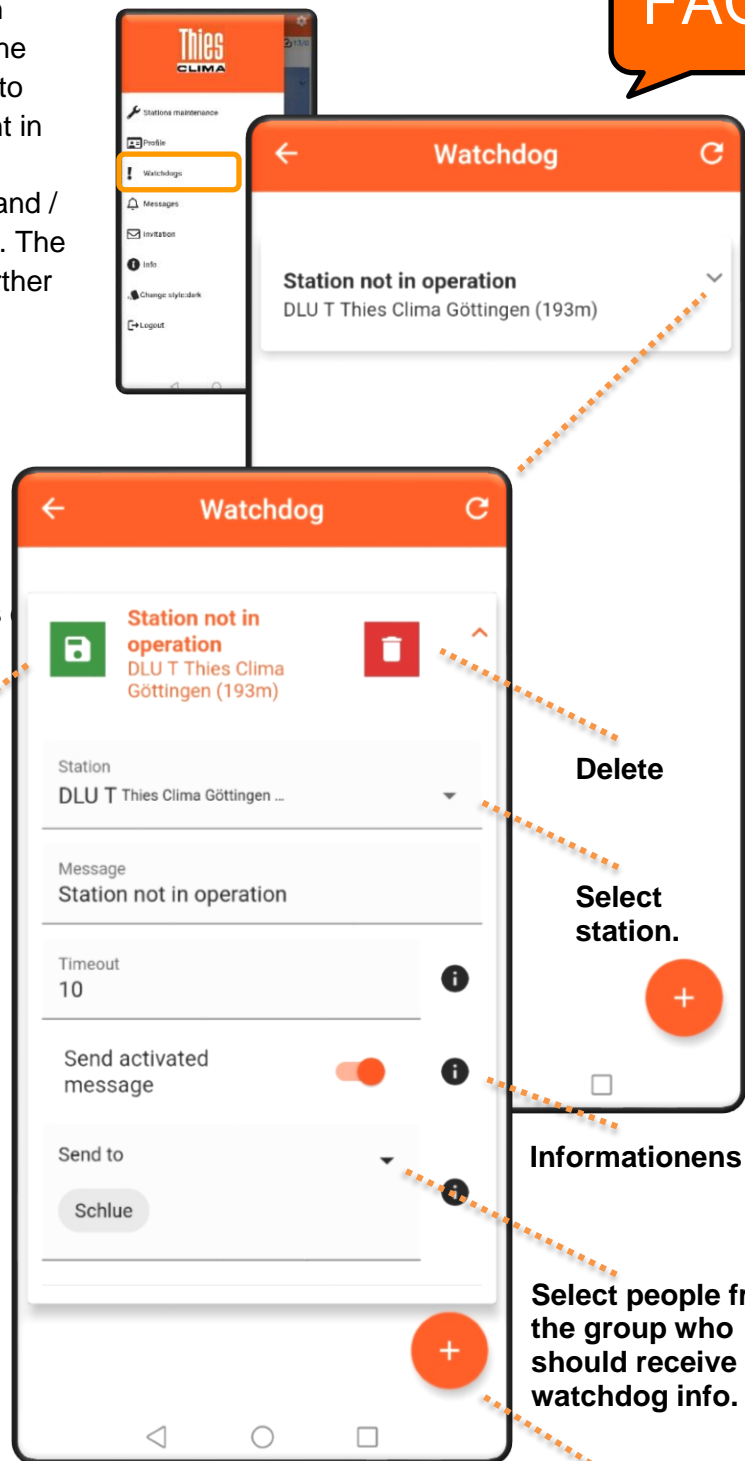

You can use the **Message** function to monitor the measurement data, measurement events and send configured messages or measured values by e-mail and / or push messages. You can configure the type of transmission via the button **Profile**. The i-Buttons are available in the app for further information.

In the area **Profil → Event management**, you can buy the watchdog and messages function as an Applnn buy. After downloading the app, all functions can be used free of charge for 1 month.

Delete Informations

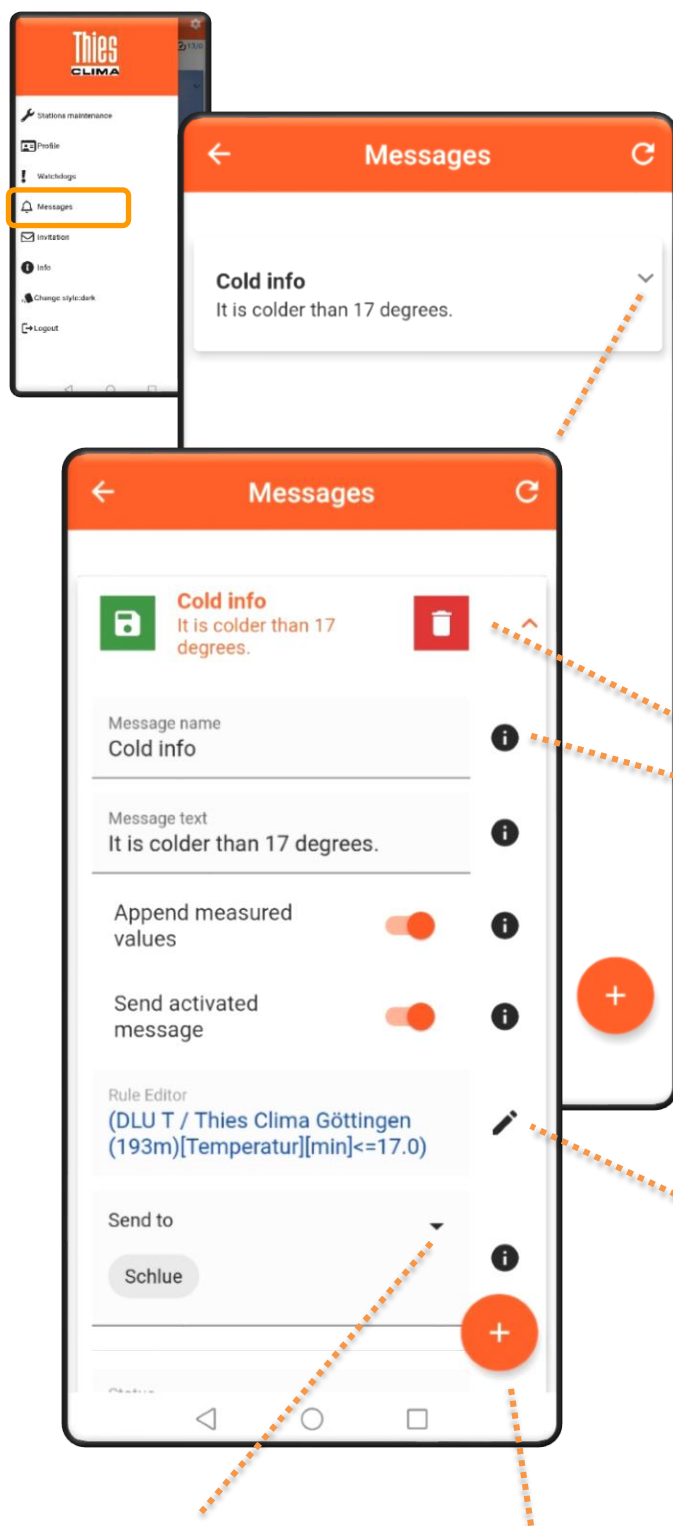

Select people from the group who should receive a message.

Create more messages.

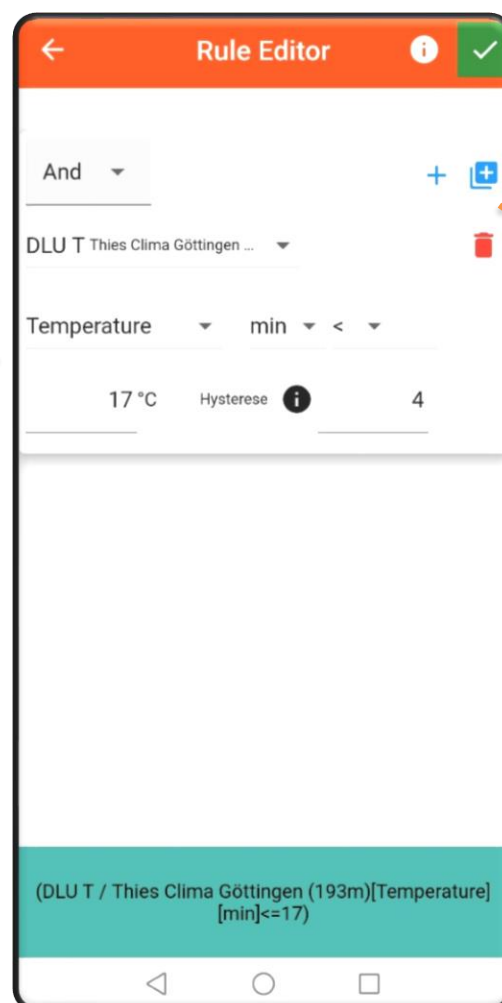

Enter further rules.

FAQ

As an administrator of a group, you can invite other members to the group as guests by **Invitation**.

Members are already registered users in the Thies Cloud.

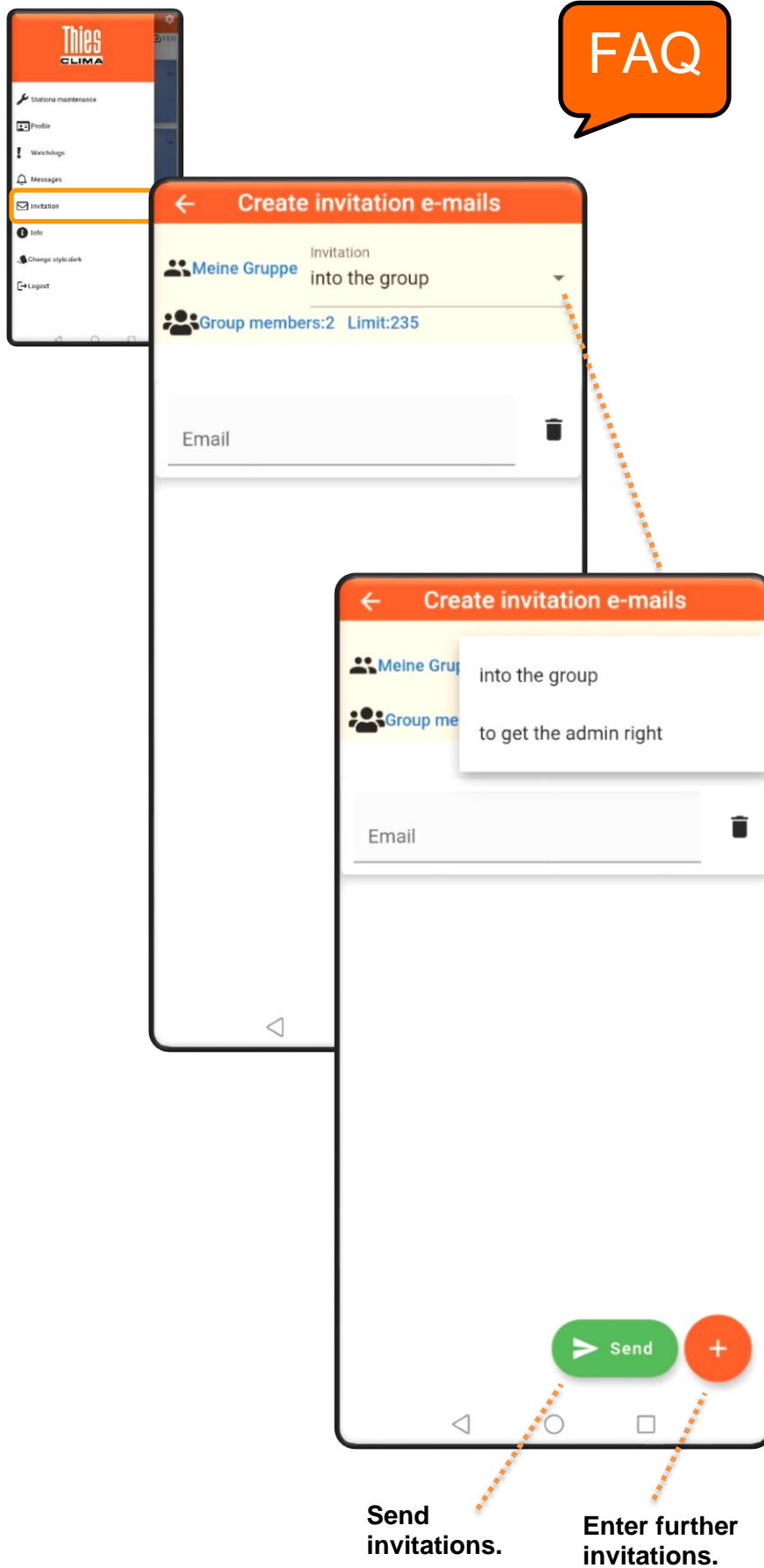

Send
invitations.

Enter further
invitations.

The software version is displayed via **Info**, the language setting are managed here.

Your user rights and the group assignment are displayed.

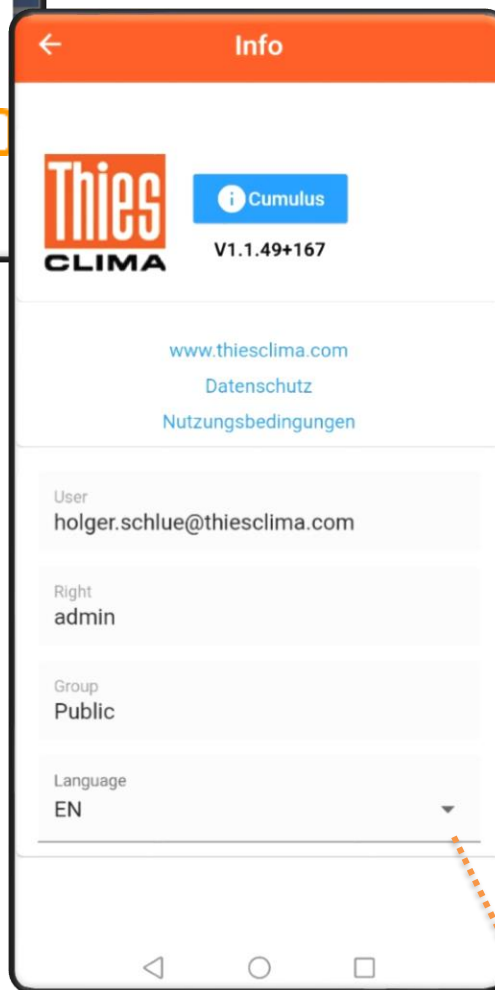
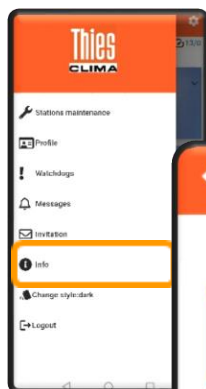

Choose a language.

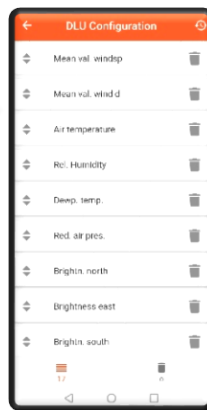
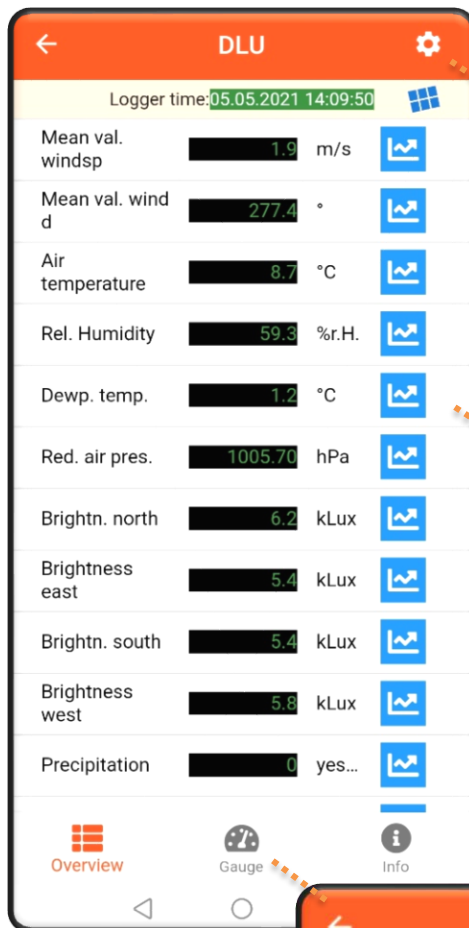

FAQ

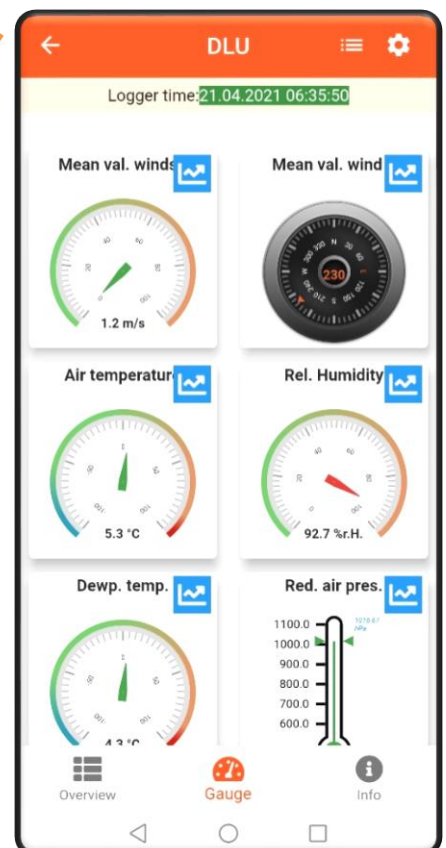
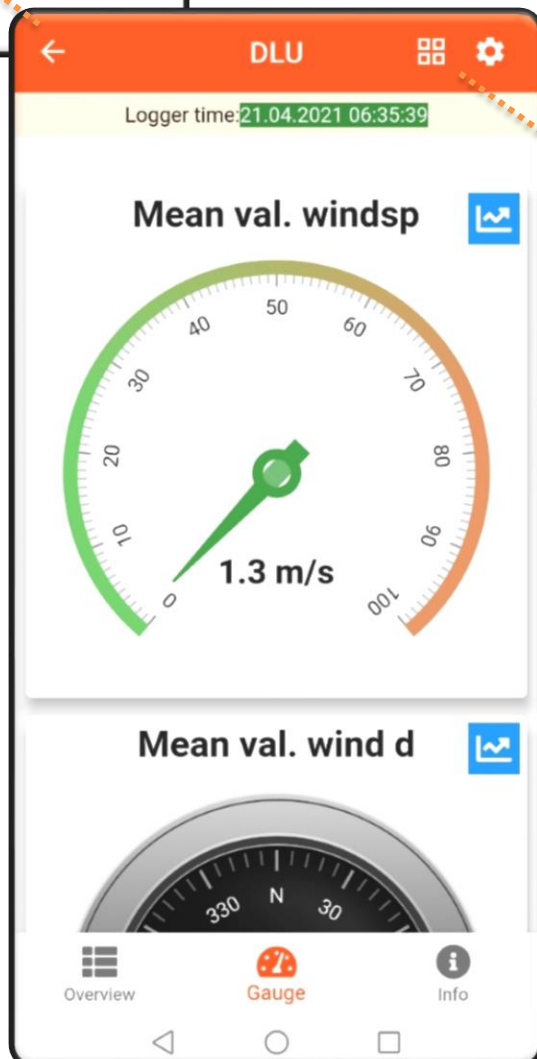
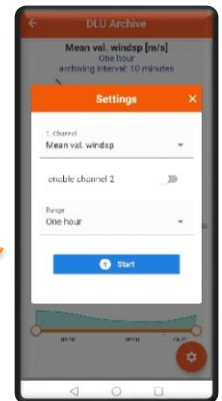
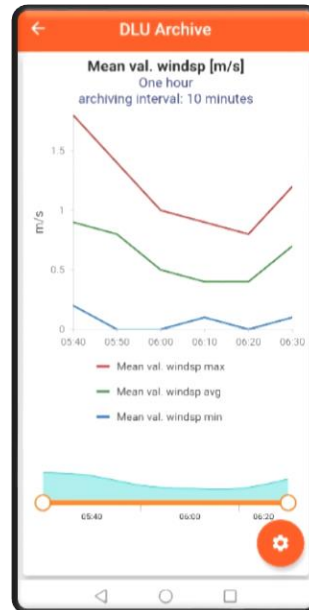

Display of archive values

FAQ

This setting can be used to activate channel 1 and channel 2. Select the measured variables for evaluation and set the time range for the archive values.

The archive values are updated via the **Start button**.
aktualisiert.

How is data exchanged?

- The Cloud polls the station data in fixed cycles. The polling interval depends on the archiving interval set.
- Normally, it is not possible to send values every second
- If a User displays the instantaneous values, a channel is opened to transmit the instantaneous values.
- This channel is kept open for as long as the User requests instantaneous values.
- The instantaneous values are updated every 5 seconds in the apps.
(-> Caution: Possibly a cost trap with GPRS)

*If several users are displaying instantaneous values at the same time:
Does this lead to an additional load for my station?*

- No, the channel for instantaneous values is opened only once by the cloud. It is closed as soon as no user requests the display of instantaneous values.

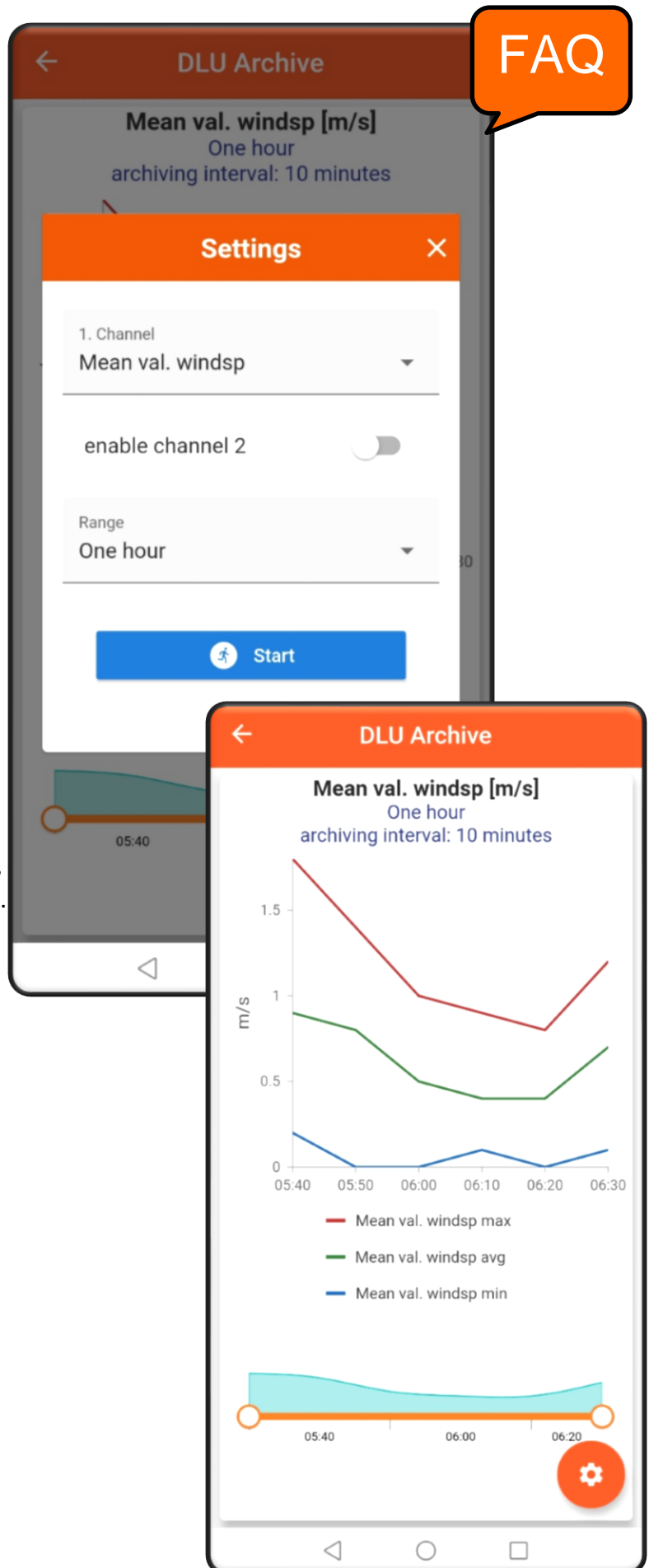

Channel configuration of the instantaneous value display

FAQ

With this function you can configure the channels to display the Instantaneous value.

With the symbol you can switch the channels to invisible or make them visible again.

With the help of "Drag and Drop" on the 3 lines you can move the channels and determine the order in which the Instantaneous values are displayed.

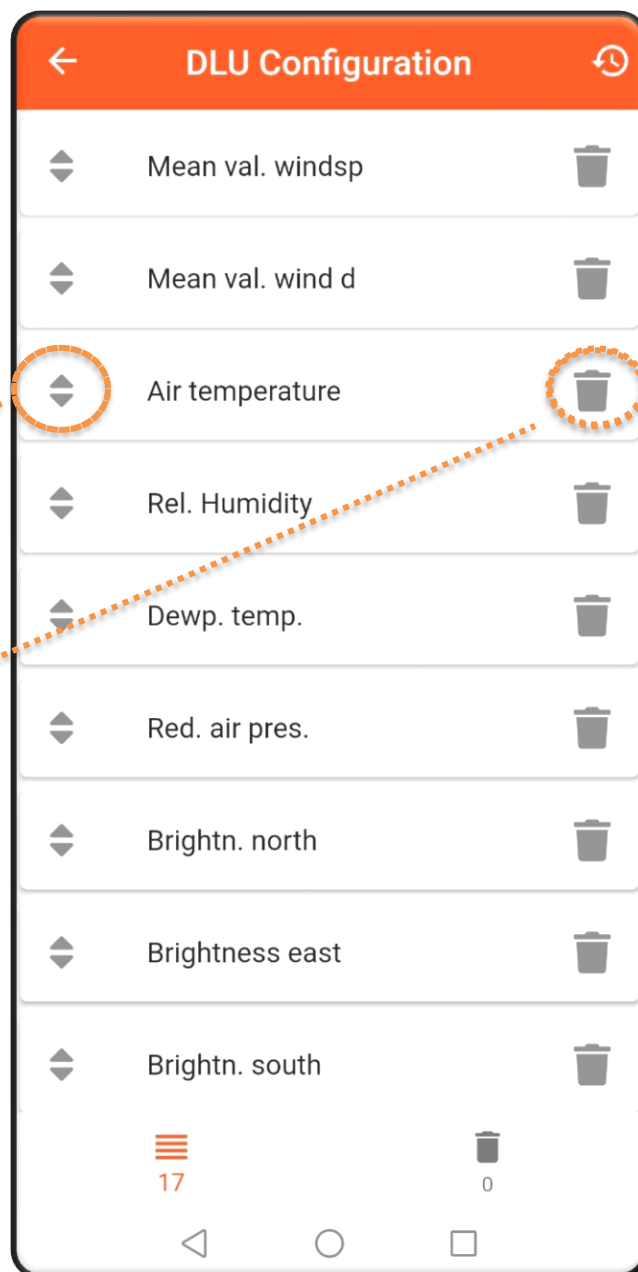

Befehlshistorie, Befehle an das Gerät senden

FAQ

With this function you can send new or changed commands to the data logger and get an overview of how the data logger is currently configured.

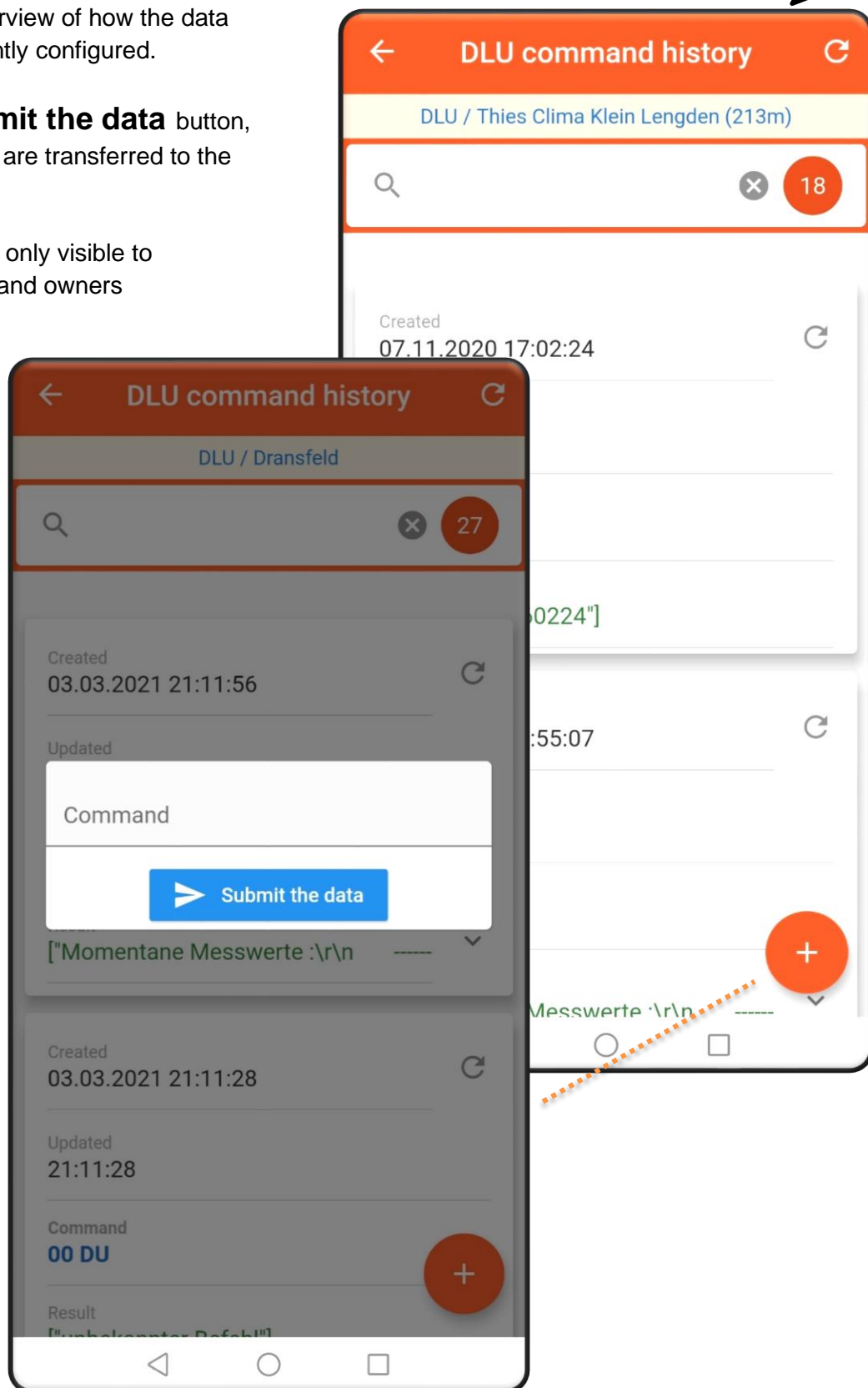

With the **Submit the data** button, the commands are transferred to the logger.

This function is only visible to administrators and owners



Logger Informations

FAQ

 **DLU** 

Logger time: 21.04.2021 06:36:11

Name

DLU

Guid

{5335-3100-4A4E-594A-3330-3430-3535-3034}

Active configuration

{{61A-9908-B-2E-A1-4-0EF--96B3--DD2-35AB-5E31-A}}

Created

25.03.2020 13:13:45

Updated

21.04.2021 08:36:14

Instant data updated

21.04.2021 08:36:14

 Overview

 Gauge

 Info

Download Archive Data

FAQ

With this mask you can set the period for the archive values which you want to download. Pressing the **Start** button starts the download.

This function is only visible to administrators and owners

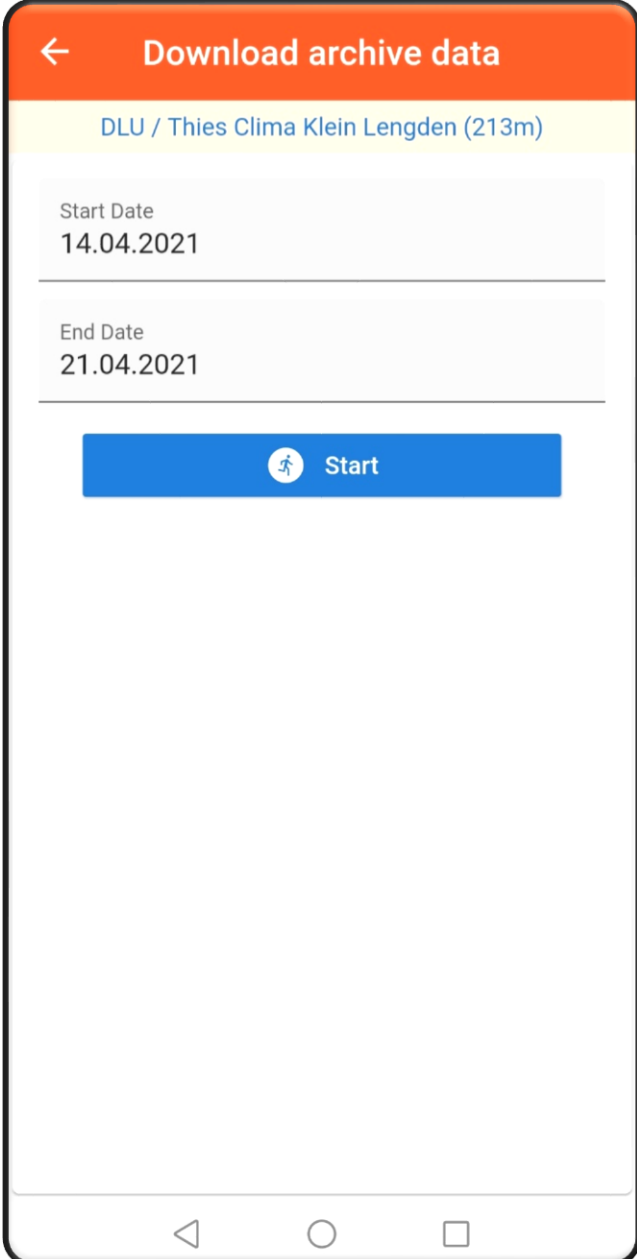

The screenshot shows a mobile application interface for downloading archive data. At the top, there is an orange header bar with a back arrow icon and the text "Download archive data". Below the header, a yellow bar displays the location "DLU / Thies Clima Klein Lengden (213m)". The main form area has two input fields: "Start Date" with the value "14.04.2021" and "End Date" with the value "21.04.2021". Below these fields is a blue button with a white play icon and the text "Start". The bottom of the screen shows the standard Android navigation bar with back, home, and recent apps icons.

Display the stations on a map

FAQ

The location overview of your data logger:

With the zoom function you can enlarge the map.

If you are tapping the marker the station information is displayed.

When you are tapping the marker, a diamond with an arrow and a map app are displayed. With this button you can navigate directly to your station.

With a CLICK on the button, the following functions can be accessed: Measured value overview, calling up archive values, downloading archive values and calling up the command history.



Selection of the displayed stations

FAQ

The slide control can be used to set the station overview on the **map** (click me) or for the **list view** (click me).

You can choose between your own stations or favorites.

You can mark the favorites with the STAR in the **list view** of the station overview.

The number of stations you can see / the number of stations where you have admin rights.



Measured value representations

FAQ

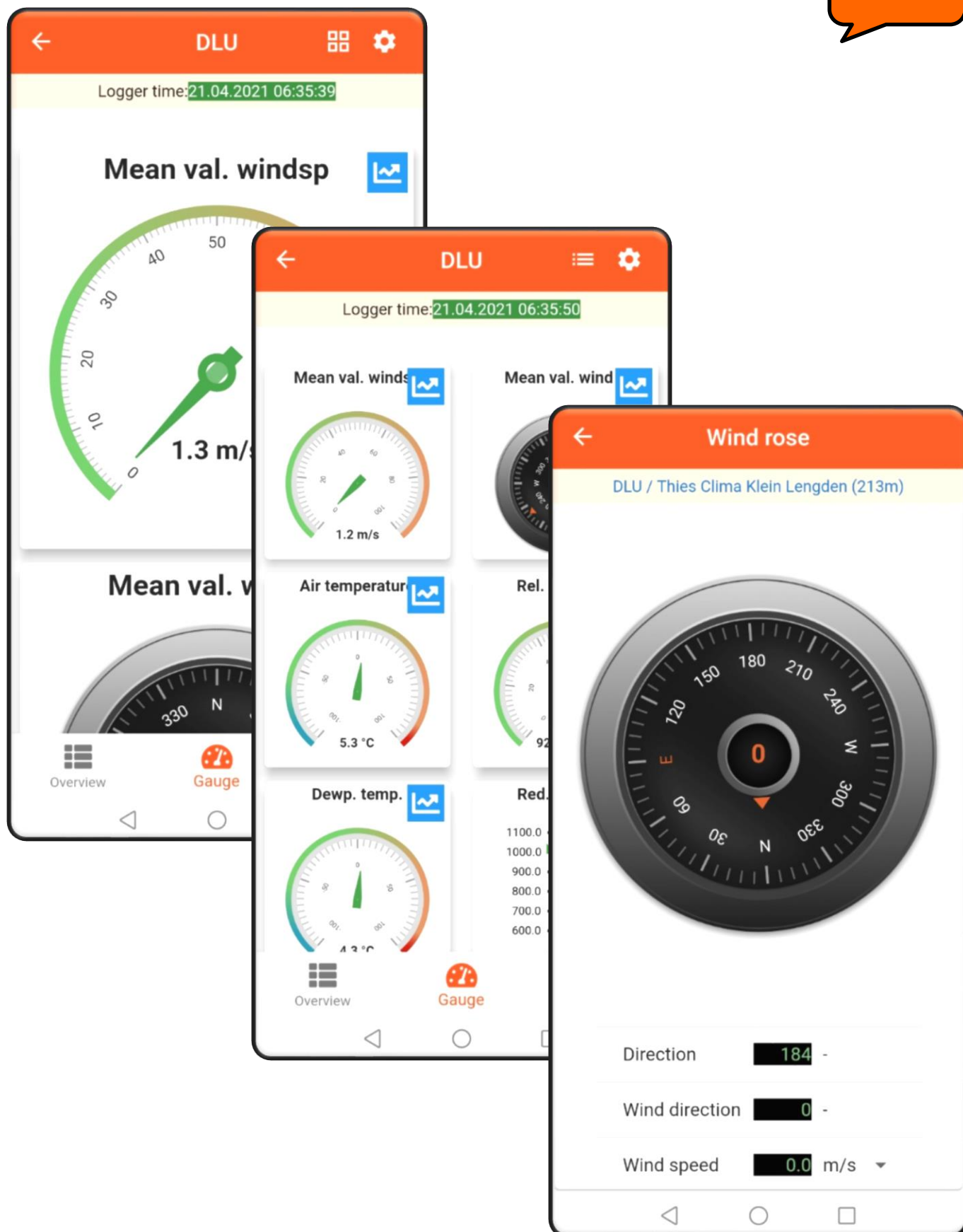

Stations Overview expanded

FAQ

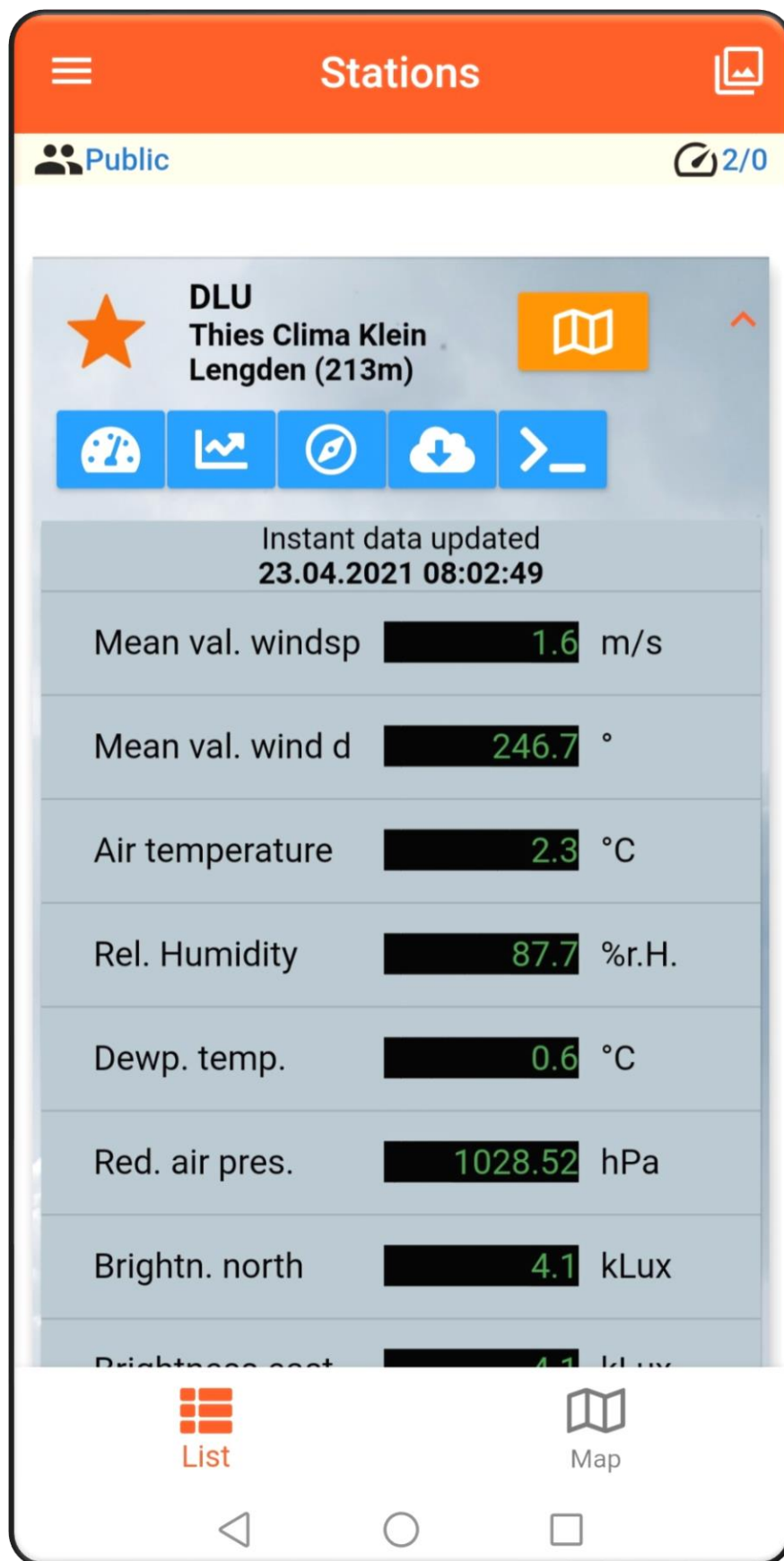

FAQ



Start screen

How can I register a station in the Cloud?

- With the purchase of a DLU, a 32-digit code is supplied, which is shown as a QR code on the DLU display. By scanning the QR code with the app, the station is registered with your name.

What is the user concept?

- There are three different types of users: Guest, owner and administrator
- After the first registration you are automatically a guest. If you registered a device, you automatically become the owner. If a new group is created when a device is registered, you are also an administrator of the group.

What is a Guest?

- Does not have an own station
- Can see the data in the stations of the relevant group
- Every customer who registers in the cloud for the first time is initially a Guest, and automatically a member in the 'Public' group

What is an Owner?

- A Guest who registers a station becomes an owner
- Can own one or more stations
- Can see the data in the stations of the relevant group
- Can download data from their own station(s)
- Can send commands to their own station(s)

What is an Administrator?

- Is the manager of a group
- Can invite other users to the group
- Has access to the data in all stations of the group
- Can assign administrator rights to the other members (guests and/or owners) in the group

How do I become a owner?

- By registering a station

How do I become an administrator?

- If a new group is created at the same time when registering a device, you automatically become the administrator of the group
- If another administrator in the group assigns you administrator rights.

What are groups?

- Groups consist of at least one person

- At least one person in the group is the owner of a station
- Members of a group can only see the stations in that group
- Groups are not closed in themselves. Users have no access to the stations of other groups. Stations of other groups are not visible.

How can I create a group?

- It is possible to create a new group when registering a new station.

How do I change to another group?

- For this, you need an invitation into the new group. This is done by the group's administrator, who sends an e-mail with a link. Clicking on this link takes you to the new group.

What happens to my station(s) if I change to another group?

- Because stations are always assigned to a specific person, the stations are also moved to the other group.

Can I simultaneously be a member in different groups?

- With an account, you can only be a member in one group.

Can I leave a group by myself?

- Yes, you can leave a group by yourself and go back into the 'Public' group.

Can I go back after that?

- No, for this, you need a new invitation from the group's administrator

How many languages are supported?

- English and German
- The language is stored in the User account
- The language is selected during registration
- When the app is started, the application runs in the stored language
- The language can be changed in the app at any time

Can customers test the cloud without hardware?

- Yes, any person can open an account using their e-mail address
- Accounts can be used with Android, iOS and Web
- After the first registration, the customer is a member in the 'Public' group

Can a customer open several accounts?

- Yes, but he/she needs different e-mail addresses. Every account is assigned to a specific e-mail address

How is data exchanged?

- The Cloud polls the station data in fixed cycles. The polling interval depends on the archiving interval set.
- Normally, it is not possible to send values every second
- If a User displays the instantaneous values, a channel is opened to transmit the instantaneous values.
- This channel is kept open for as long as the User requests instantaneous values.
- The instantaneous values are updated every 5 seconds in the apps.
(-> Caution: Possibly a cost trap with GPRS)

If several users are displaying instantaneous values at the same time: Does this lead to an additional load for my station?

- No, the channel for instantaneous values is opened only once by the cloud. It is closed as soon as no user requests the display of instantaneous values.

What does the app cost?

- The app is free of charge and can be downloaded from PlayStore or AppStore
- Future functions, e.g. watchdogs function and limit monitoring, might be subject to a charge

Can a firewall block the data transfer?

Yes, information technology must allow access to the following URLs / addresses / ports:

- <http://deb.debian.org/>
- <http://repos.rcn-ee.com/>
- <https://www.thiescloud.com>
- Port 443
- Sending ping on www.thiescloud.com must be allowed
- Access to NTP time synchronization must be allowed, Address: de.pool.ntp.org or at.pool.ntp.org with Port 123

How do I get the data from the cloud to my local PC?

- Data can be downloaded via the Download archive values menu
- Data can be continuously downloaded via the Thies Cloud Data Windows Service (9.1798.12.000) or Thies Cloud Data Linus Service (9.1798.12.011). For further information, please contact your sales contact.

Which measured values are necessary to display the current weather situation to be shown as a background graphic?

- Wind speed, global radiation or 3 brightness's (east, south, west), SYNOP code or precipitation intensity or precipitation status, air temperature, geographical position (can also be entered manually in the logger)
- The THIES compact weather stations WSC11 (4.9056.10.000) and Climasensor US (4.9200.00.000) support the display of the weather situation.

App Login- and Logout, Change Password

Start screen

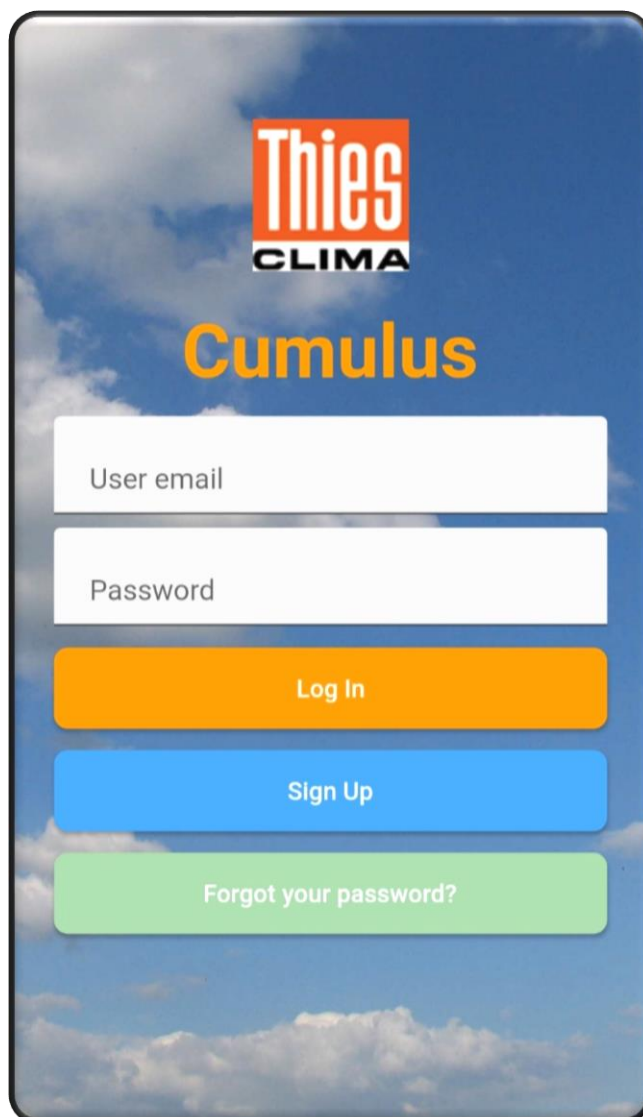
The image shows a mobile app login screen for 'Thies CLIMA Cumulus'. The background is a blue sky with white clouds. At the top center is the 'Thies CLIMA' logo, with 'Thies' in white on an orange square and 'CLIMA' in black below it. Below the logo, the word 'Cumulus' is written in a large, orange, sans-serif font. Underneath 'Cumulus' are three white input fields: the first is labeled 'User email', the second is labeled 'Password', and the third is empty. Below the input fields are three buttons: an orange 'Log In' button, a blue 'Sign Up' button, and a green 'Forgot your password?' button. All buttons have rounded corners and white text.

You can also run this app from your PC:

<https://www.thiescloud.com/cumulus>

**Please contact us for your system requirements.
We will be pleased to assist.**

ADOLF THIES GMBH & CO. KG

Meteorology and environmental metrology
Hauptstraße 76 · 37083 Göttingen · Germany
Phone +49 551 79001-0 · Fax +49 551 79001-65
info@thiesclima.com

www.thiesclima.com

